



# FumeCube

What to specify...

1. Single or Dual Arm System

2. Voltage

3. Pre-filter

4. Main filter

1	2	Single Arm System		Dual Arm System	
<b>Voltage</b>		<b>230V ± 10%</b>	<b>120V ± 10%</b>	<b>230V ± 10%</b>	<b>120V ± 10%</b>
<b>Part number</b>		<b>072066</b>	<b>072067</b>	<b>072065</b>	<b>072068</b>
<b>Voltage</b>		0.14 kVv	0.107 kVv	0.14 kVv	0.107 kVv
<b>Frequency</b>		50Hz / 60 Hz	50Hz / 60 Hz	50Hz / 60 Hz	50Hz / 60 Hz
<b>Cabinet height</b>		366 mm	366 mm	366 mm	366 mm
<b>Cabinet width (not inc hose)</b>		308 mm	308 mm	308 mm	308 mm
<b>Cabinet depth (not inc hose)</b>		294 mm	294 mm	294 mm	294 mm
<b>Cabinet weight (inc filters)</b>		17 Kg	17 Kg	17 Kg	17 K

3

## Pre-filter Pad



Options:  
Pack of 4

Code:  
200225

4

## Main filter



Options:  
HEPA/Chemical (std)  
Chemical  
Cleanroom

Code:  
110536  
110537  
110538

Note: FumeCubes sold prior to December 2008 may require different filters. Please contact your local distributor for advice.



## Single Arm System



Supplied with:

- 1 x Filter + pre-filter pad
- 1 x 51mm x 2m flexible hose [black]
- 2 x Connecting cuffs [black]
- 1 x Clamped bracket
- 1 x 38mm stainless steel flexible arm and valve
- 1 x 38mm pen nib nozzle & 1 x conical cowl.

## Dual Arm System



Supplied with:

- 1 x Filter + pre-filter pad
- 2 x 51mm x 2m flexible hose [black]
- 4 x Connecting cuffs [black]
- 2 x Clamped bracket
- 2 x 38mm stainless steel flexible arm and valve
- 2 x 38mm pen nib nozzle and 2 x conical cowl.

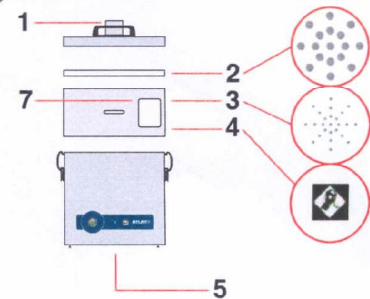

Legend:

- 1) Air inlet.
- 2) Pre filter.
- 3) Main Filter (HEPA location).
- 4) Main Filter (Carbon location).
- 5) Clean air returned to workplace.
- 7) Filter identification label.

In cleanroom filters, positions 3&4 are reversed.

## Controls

### Visual and Audible Filter Blocked Warning

Alerts the operator when a filter starts to block so that a replacement filter can be acquired and downtime can be avoided.

### LED Filter Status

- Green = Filter OK
- Yellow = Filter nearly full
- Red = Filter full, replacement required

## System Features...

- Automatic electronic flow control - maintains a constant extraction rate even as the filter blocks
- Adjustable airflow
- VariColour filter blocked warning system
- Low capital and running costs
- Quick change pre-filters deliver longer filter life
- Submicronic (HEPA) filtration removes 99.997% of particles down to 0.3 microns
- Activated carbon filtration removes harmful gas
- Simple to install and quiet in operation
- Easy to relocate
- Precision made from stainless steel

## Includes:

- 1 x Main filter
- 4 x Pre-filter pad
- 1 or 2 Arm Kit
- 1 x Power cable (see pg39)

## Accessories

Please see the accessories section at the back of this brochure.